

DYNAFLUX A.C. SYNCHRONOUS MOTORS

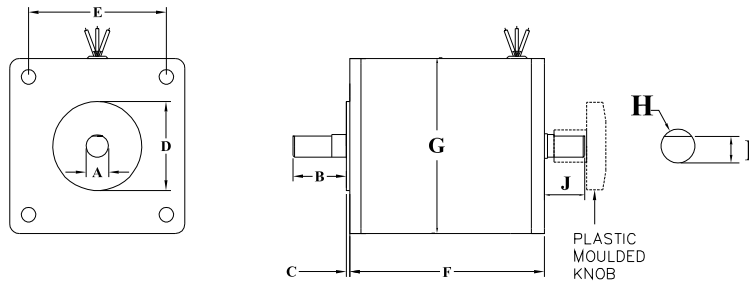

MODEL	ELECTRICAL SPECIFICATIONS.				MECHANICAL SPECIFICATIONS.										
	VOLTAGE IN VAC	SPEED IN RPM	CURRENT IN AMPS	TORQUE IN KG.CM	A	B	C	D	E	F	G	H	I	J	WEIGHT (KG)
MIS-3	240	60	0.09	3	10	26	1	35	72X72	60	87	10	8	26	1.2
MIS-7	240	60	0.10	7	10	26	1	35	70X70	56	87	10	9	26	1.2
MIS-10	240	60	0.16	10	10	26	1	55	85X85	69	108	10	8	26	2.5
MIS-20	240	60	0.30	20	15	32	2	55	85X85	80	107	15	13.5	26	3.5
MIS-28	240	60	0.35	28	15	33	1	55	85X85	103	108	15	13	26	4.2
MIS-40	240	60	0.70	40	15	50	2	55	85X85	156	107	15	13	26	8.0
MIS-60	240	60	1.30	60	15	51	2.5	55	85X85	202	107	15	13	26	10.0
MIS-100	240	60	1.70	100	15	51	2.5	55	85X85	169	107	15	13	26	10.0

DYNAFLUX A.C. SYNCHRONOUS INLINE GEARED MOTORS

3 KG & 7 KG INLINE GEARED MOTOR

10, 20 KG & 28 KG INLINE GEARED MOTOR

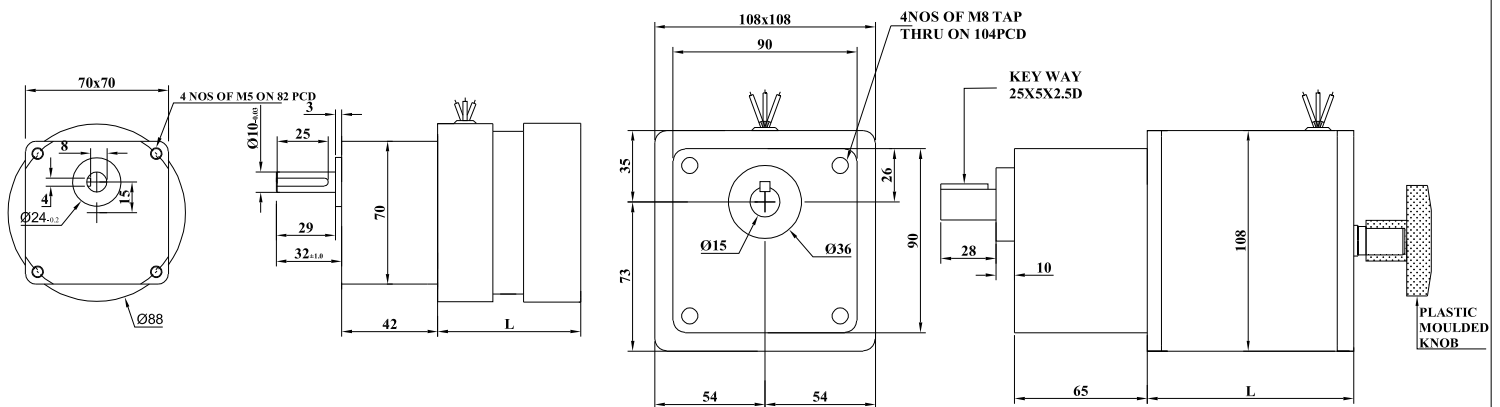

MODEL	VOLTAGE IN VAC	SPEED IN RPM				CURRENT IN AMPS	TORQUE IN KG.CM				L	WEIGHT (KG)
		N1	N2	N3	N4		T1	T2	T3	T4		
		MIS-3 IN	240	0.3	2		6	12	0.09	200		
MIS-7 IN	240	0.3	2	6	12	0.10	300	200	80	40	56	3.5
MIS-10 IN	240	0.3	2	6	12	0.16	400	300	100	50	69	4.5
MIS-20 IN	240	0.3	2	6	12	0.30	500	400	120	60	80	6.5
MIS-28 IN	240	0.3	2	6	12	0.35	600	500	140	70	103	7.5